

**TRB–AASHTO
Policy Committees
Summer Meeting**
Mapping the Future

June 25–27, 2012

Arnold and Mabel Beckman Center
of the National Academies
Irvine, California



TRB Standing Committees and Subcommittees

- Committee on Revenue and Finance
- Committee on Congestion Pricing
 - Subcommittee on Pricing Outreach
 - Subcommittee on Multimodal Pricing
 - Joint Subcommittee on Vehicle Miles Traveled Revenues
 - Joint Subcommittee on Pricing Economics
- Committee on Transportation Economics
- Committee on Transportation and Economic Development
- Committee on Transportation Demand Management
 - Joint Subcommittee on Parking Management

AASHTO Subcommittee

- Subcommittee on Transportation Finance Policy

BECKMAN CENTER FLOOR PLAN

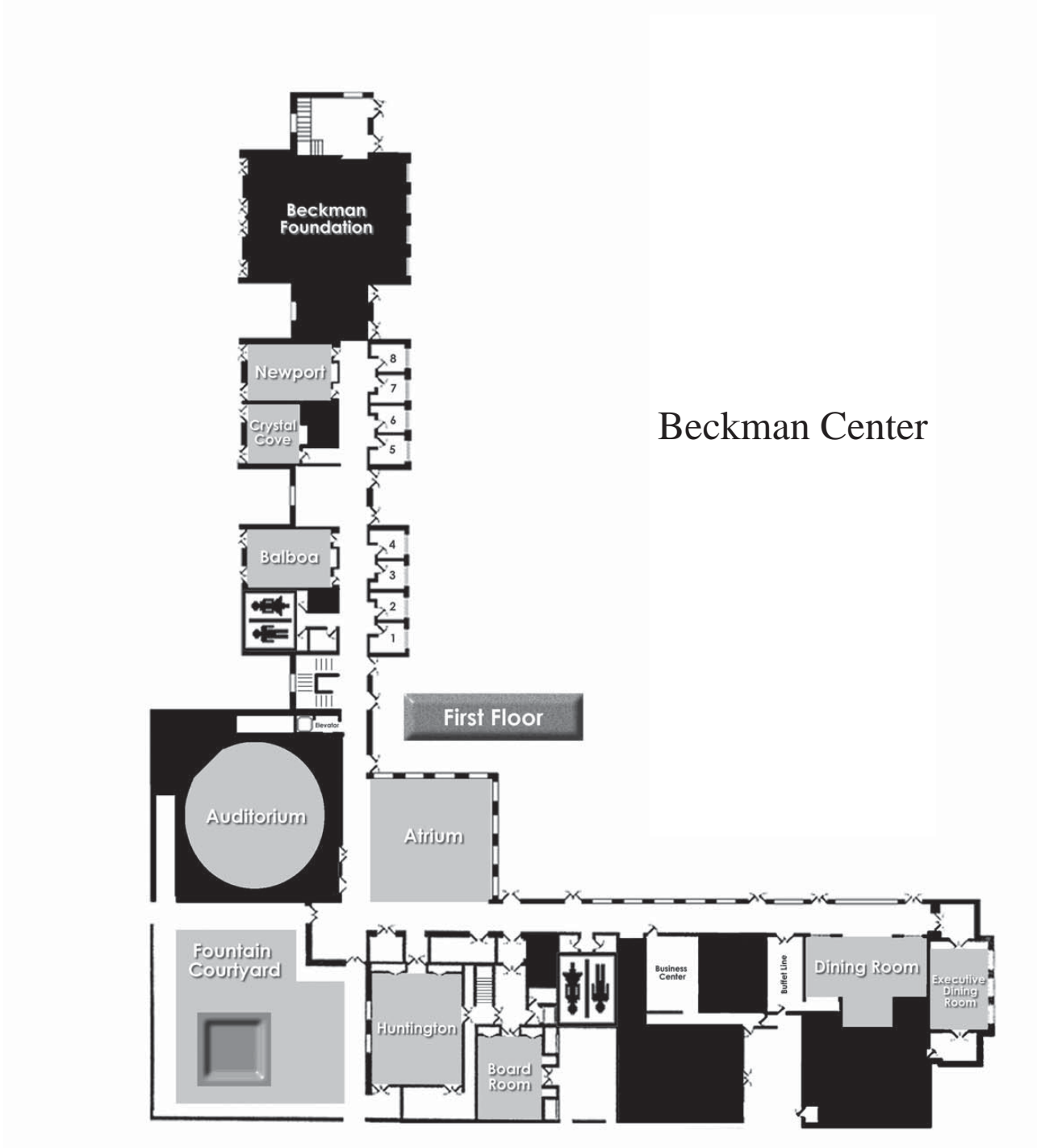

Beckman Center

June 25-27, 2012



OPENING SESSION



Moderator

Patrick D. Jones, Executive Director and CEO
International Bridge, Tunnel, and Turnpike Association

Patrick D. Jones is executive director and chief executive officer of the International Bridge, Tunnel, and Turnpike Association (IBTTA). With headquarters in Washington, D.C., IBTTA is the worldwide association for the owners and operators of toll highways, bridges, and tunnels and the companies that provide products and services to the toll industry. IBTTA has several hundred corporate members that operate toll facilities in 30 states in the United States and in 21 countries on five continents around the world.

PANELISTS



Dougherty



Heminger



Kelly

Top row, left to right:

- **Malcolm Dougherty**, Director, California Department of Transportation
- **Steve Heminger**, Executive Director, Metropolitan Transportation Commission
- **Brian P. Kelly**, Acting Secretary, California Business, Transportation, and Housing Agency

Left

- **Peter J. (Jack) Basso**, Director of Program Finance and Management, American Association of State Highway and Transportation Officials

Right

- **Mark Norman**, Director, Technical Activities Division, Transportation Research Board



Basso



Norman

June 25-27, 2012



GUEST PANELISTS' BIOGRAPHIES

Malcolm Dougherty is Director of the California Department of Transportation (Caltrans), where he leads the \$11 billion organization and its 20,000 employees who build, maintain, and operate the 50,000 lane miles of California's world-class transportation system. He is also a member of California's Toll Bridge Program Oversight Committee, which provides project oversight on the seismic retrofit of the state's toll bridges, including the iconic \$6.28 billion San Francisco–Oakland Bay Bridge.

During his 20 years with Caltrans, Dougherty has served in high-profile management positions: Chief Deputy Director, where he advised and assisted the director with all aspects of Caltrans' policies and operations; District Director in the Fresno area, where he was responsible for Planning, Project Management, and Maintenance for the district's five counties, as well as the Capital Project Delivery Program for the Central Region, which spans from the Pacific Coastline to Nevada, and from Amador County to Kern County. He also held management positions in Design, Project Management, Maintenance, and Traffic Operations. Before coming to Caltrans, he worked for a consultant with a focus on land development and municipal engineering.

Dougherty is a graduate of Rutgers University with a bachelor of science degree in civil engineering.

Brian P. Kelly was appointed by the governor in March 2012 to lead California's Business, Transportation, and Housing Agency. As Acting Secretary, he oversees 12 departments and several economic development programs and commissions with more than 45,000 employees and a budget of \$18 billion. The agency's operations address issues that include transportation, public safety, affordable housing, international trade, financial services, and tourism and directly impact the state's economic vitality and quality of life.

Kelly has been at the center of most of the major transportation policy decisions in California for the past decade and a half, having served as chief transportation policy consultant for four successive Senate President pro Tempores. He was executive staff director for Senate President pro Tempore Darrell Steinberg beginning in 2008; executive principal consultant for Senate President pro Tempore Don Perata from 2004 to 2008; principal consultant for Senate President pro Tempore John Burton from 1998 to 2004; and assistant consultant for Senate President pro Tempore Bill Lockyer from 1995 to 1998.

Kelly's degree in government and journalism is from California State University, Sacramento.

Steve Heminger is Executive Director of the Metropolitan Transportation Commission (MTC), which is the regional transportation planning and finance agency for the nine-county San Francisco Bay Area. MTC allocates more than \$1 billion per year in funding for the operation, maintenance, and expansion of the Bay Area's surface transportation network.

Since 1998, MTC has served as the Bay Area Toll Authority (BATA), responsible for administering all toll revenue from the seven state-owned bridges. BATA has a "AA" credit rating and plans to issue more than \$9 billion in toll revenue bonds to finance bridge, highway, and transit construction projects over the next several years. MTC also functions as the region's service authority for freeways and expressways and operates a fleet of 80 tow trucks and 2,600 roadside call boxes to assist motorists in trouble. MTC also manages the FasTrak electronic toll collection system, the Clipper universal fare card program for public transit, and the popular 511 traveler information telephone number and website. Heminger was also appointed to serve on the National Surface Transportation Policy and Revenue Study Commission.

As chairman of Caltrans' Toll Bridge Program Oversight Committee, Heminger also is overseeing construction of the new east span of the San Francisco–Oakland Bay Bridge, which is the largest public works project currently underway in the United States. He also serves as vice president of the Board of Trustees for the Mineta Transportation Institute and president of the Board of Directors for the Association of Metropolitan Planning Organizations.

Heminger received a master of arts degree from the University of Chicago and a bachelor of arts from Georgetown University.

June 25–27, 2012



CONFERENCE AGENDA

Monday, June 25

Bus Service Provided from Marriott Newport Beach Hotel to Beckman Center

All departure times are approximate: 7:00 a.m., 7:30 a.m., and 8:00 a.m.

7:15 a.m.–8:15 a.m., *Dining Room*

Breakfast

8:30 a.m.–10:00 a.m., *Auditorium*

Opening Plenary Session: Mapping the Future

Patrick Jones, International Bridge, Tunnel, and Turnpike Association, *presiding*

Panelists:

Peter J. (Jack) Basso, American Association of State Highway and Transportation Officials

Malcolm Dougherty, California Department of Transportation

Steve Heminger, Metropolitan Transportation Commission, Oakland, California

Brian Kelly, Business, Transportation, and Housing Agency, State of California

Mark Norman, Transportation Research Board of the National Academies

10:00 a.m.–10:15 a.m., *Foyer*

Morning Break

10:30 a.m.–12:30 p.m., *Auditorium*

Session: Measuring and Communicating Transportation Demand Management (TDM) Results and Value

William Loudoun, SKS Associates, *presiding*

This session will examine new tools and approaches to measure the value of TDM strategies, including uses for long-term and regional planning applications. Following four presentations, attendees will have an opportunity to offer their own TDM evaluation examples and to discuss TDM evaluation research priorities to be emphasized by the TDM Committee in the future.

Using Mobile Phones to Track and Influence Multimodal Travel Behavior

Philip Winters, Center for Urban Transportation Research at the University of South Florida

Quantifying Benefits and Costs of TDM Actions for Corridor Studies and Regional Transportation Plans

Howard Jennings, Arlington County Commuter Services

TDM Performance Indicators and Measurement for TDM Strategic Plans

Eric Schreffler, ESTC

Forecasting Pasadena's TDM Strategies Using the Mode Shift Analysis Tool

Gustavo Jiminez, Fehr and Peers

Monday, June 25, 2012



10:30 a.m.–12:30 p.m.

TRB Subcommittee Meetings

TRB Subcommittee on Multimodal Pricing, *Board Room*

TRB Vehicle Miles Traveled Revenues Joint Subcommittee (ABE25 and ABE10), *Huntington Room*

12:30 p.m.–1:30 p.m., *Dining Room*

Lunch Buffet

12:30 p.m.–3:30 p.m.

Technical Tour SR-91: Group No. 1

20-person maximum with preregistration required. Transportation, box lunches, and beverages provided.

Kirk Avila of the Orange County Transportation Authority (OCTA) will provide participants with an overview of the project, including background information leading to OCTA's purchase of the facility, the congestion management pricing process, recent statistics, and future plans. The group will proceed to the traffic operations center, where they will observe the facility in action.

1:45 p.m.–3:45 p.m. (3:45 p.m.–4:00 p.m. afternoon break, *Foyer*)

TRB Committee Meeting

Transportation Demand Management (ABE20), Part 1 (business meeting), *Board Room*

1:45 p.m.–5:45 p.m. (3:45 p.m.–4:00 p.m. afternoon break, *Foyer*)

TRB Committee Meetings

Transportation Economics (ABE20), *Executive Dining Room*

Revenue and Finance (ABE10), *Huntington Room*

Transportation and Economic Development (ADD10), *Balboa Room*

Bus Service Provided from Beckman Center to Marriott Newport Beach Hotel

Departure time is 6:00 p.m.

6:30 p.m.–7:30 p.m., *Marriott Hotel*

Welcome Reception

Tuesday, June 26

Bus Service Provided from Marriott Newport Beach Hotel to Beckman Center

All departure times are approximate: 6:30 a.m., 7:00 a.m., and 7:30 a.m.

7:00 a.m.–8:00 a.m., *Dining Room*

Breakfast

Monday, June 25, and Tuesday, June 26, 2012



8:00 a.m.–9:00 a.m.

TRB–AASHTO Combined Meetings

TRB Congestion Pricing (ABE25), Transportation Economics (ABE20), and Revenue and Finance Committees (ABE10), *Huntington Room*

TRB Transportation and Economic Development Committee (ADD10) with AASHTO Subcommittee on Transportation Finance Policy, *Executive Dining Room*

8:00 a.m.–10:00 a.m., *Board Room*

**Session: Transportation Demand Management (ABE50), Part 2
The Future of TDM: What Is the Big Picture and Where Do We Go from Here?**

Lori Diggins, LDA Consulting; and Philip Winters, Center for Urban Transportation Research at the University of South Florida, *presiding*

The TDM Committee's recent survey conducted by TDM community members highlighted several "TDM future and big picture" topics as primary TDM research needs: travel demographics that might influence its attractiveness, innovative financing approaches, its role as a mobility measure versus trip reduction measure, and effective public–private partnerships for its funding and implementation. Collectively, these topics are related to how to position TDM for future growth and greater integration with other transportation and regional policies. This session will involve attendees in a facilitated discussion about current big picture TDM issues and the research needed to expand its visibility and applications.

9:15 a.m.–10:15 a.m.

TRB Combined Meetings

TRB Transportation Economics (ABE20) and Transportation and Economic Development (ADD10) Committees, *Executive Dining Room*

TRB Congestion Pricing (ABE25) and Revenue and Finance (ABE10) Committees, *Huntington Room*

10:00 a.m.–10:30 a.m., *Foyer*

Morning Break

10:30 a.m.–12:30 p.m., *Auditorium*

Session: Understanding the Link Between Transportation and the Economy

Mark Burris, Texas A&M University, *presiding*

What Have We Learned and Why Does It Matter? The Discourse Surrounding the Nation's Transportation Funding Crisis

Peter J. (Jack) Basso, American Association of State Highway and Transportation Officials

Assessing the Economic Benefits of Transportation Investment

Susan Binder, Cambridge Systematics, Inc.

Conditions and Performance Report to Congress: What We Get from Highway and Transit Investment

David Luskin, Federal Highway Administration

Tuesday, June 26, 2012



10:30 a.m.–12:30 p.m.

TRB–AASHTO Combined Meeting and Subcommittee Meeting

**Combined Meeting of TRB Revenue and Finance Committee (ABE10) with
AASHTO Subcommittee on Transportation Finance Policy, Huntington Room**

TRB Subcommittee on Pricing Outreach, Executive Dining Room

12:30 p.m.–1:30 p.m., Dining Room

Lunch Buffet

Optional Informal Research Roundtables over lunch

12:30 p.m.–3:30 p.m.

Technical Tour SR-91: Group No. 2

20-person maximum with preregistration required. Transportation, box lunches, and beverages provided.

Kirk Avila of the Orange County Transportation Authority will provide participants with an overview of the project, including background information leading to OCTA's purchase of the facility, the congestion management pricing process, recent statistics, and future plans. The group will proceed to the traffic operations center, where they will observe the facility in action.

1:45 p.m.–3:45 p.m.

TRB and AASHTO Subcommittee and Combined Committee Meetings

TRB Pricing Economics Joint Subcommittee (ABE20 and ABE25), Executive Dining Room

**TRB Transportation Demand Management (ABE50) and Transportation and Economic
Development (ADD10) Committees, Board Room**

AASHTO Subcommittee on Transportation Finance Policy, Huntington Room

3:45 p.m.–4:00 p.m., Foyer

Afternoon Break

4:00 p.m.–6:00 p.m., Auditorium

Session: Current Research on Parking Policy and Management

Lori Diggins, LDA Consulting, *presiding*

This session will begin with several presentations on current parking research, with a focus on the nexus of parking policy and TDM actions. Following the presentations, audience members have an opportunity for discussion of current parking research.

**Influence of Parking Supply, Price, and TDM on Commute Mode Choice in Arlington County,
Virginia**

Lori Diggins, LDA Consulting

Parking Requirements and TDM Programming in Mixed-Use Versus Single-Use Developments

Jeremy Nelson, Nelson/Nygaard

Guidance on Parking Strategies to Support Livable Communities: The MPO Perspective

Valerie Knepper, Metropolitan Transportation Commission

Tuesday, June 26, 2012



Parking Pricing Primer: New FHWA Guidance

Allen Greenberg, Federal Highway Administration

The Balancing Act Between Parking and TDM Actions to Influence Mode Split at Commercial Buildings

Sarah Stott, Arlington County, Virginia

4:00 p.m.–6:00 p.m.

TRB Committee and Subcommittee Meetings

TRB Subcommittee on Public–Private Partnerships (ABE10), *Executive Dining Room*

TRB Congestion Pricing Committee (ABE25), *Huntington Room*

Bus Service Provided Back to the Marriott Newport Beach Hotel

Departure time is 6:15 p.m.

Wednesday, June 27

Bus Service Provided from Marriott Newport Beach Hotel to Beckman Center

(All departure times are approximate: 6:30 a.m., 7:00 a.m., and 7:30 a.m.)

7:00 a.m.–8:00 a.m., *Dining Room*

Breakfast

8:00 a.m.–10:00 a.m., *Board Room*

TRB SHRP 2 Research: Workshop with Demonstration of Economic Impact Tool

Presenters: David Plazak, Transportation Research Board; and Glen Weisbrod, Economic Development Research Group, Inc.

This workshop will provide an introduction to the web-based tool, Transportation Project Impact Case Studies System (TPICS), explain how it was developed, and demonstrate its major features. This web tool is currently available for use as a beta test site.

While excellent economic impact models and assessment tools are available for detailed highway capacity planning, this screening tool can be particularly useful for stages of planning and programming when many possible project alternatives are being considered. TPICS provides agency staff and interested stakeholders with a means for establishing the range of job, income, and development impacts typically associated with various types of transportation projects in different settings. It thus facilitates consideration of economic impacts during community visioning for transportation, or during public and stakeholder involvement for long-range system planning or corridor planning.

TPICS is a web-based viewing and analysis system for a database containing 100 detailed before and after project case studies. This system includes three parts: (a) a search function that allows for user-defined screening and selection of relevant cases; (b) a case study viewer that provides user access to impact measures, discussion text, maps, and related documents; and (c) an impact estimation calculator that shows the average and expected range of impact associated with any user-defined project profile. By providing agency staff and interested stakeholders with a means for establishing the range of job, income, and development impacts typically associated with various types of transportation projects in different settings, the TPICS tool can assist transportation agencies in project planning and evaluation.

Tuesday, June 26, and Wednesday, June 27, 2012



8:00 a.m.–noon, *Huntington Room*

Congestion Pricing Workshop: When Worlds Converge—How Land Use and Current Institutions Will Evolve in a World of Road User Charges

A growing funding gap to maintain and expand the transportation network coupled with the declining purchasing power of the gas tax and political unwillingness to raise taxes for transportation at the state and federal levels has propelled an interest in road user charges, such as tolls, congestion pricing, and mileage-based user fees as part of the solution. This shift in how transportation is funded will have significant impacts on land use as well as on how public agencies (local and state DOTs, toll authorities, MPOs, and DMVs) interact and are organized.

In the first part of this two-part workshop, staff of the Urban Land Institute (ULI) will present their cutting-edge work to explore the nexus of road user charges and land use. ULI will introduce an interactive land use thought experiment for participants to consider and will share preliminary results of two recently conducted national meetings on this topic.

Part two of the workshop will focus on how public institutions are organized to succeed in a world of more ubiquitous road user charges where the lines become increasingly blurred between state DOTs, toll authorities, departments of motor vehicles, and private transportation operators. What are the institutional models and political considerations that drive such decisions? Various state and regional institutional models from Florida, North Carolina, Texas, Washington, and California will be explored, with various model permutations in other states. What are the pros and cons for such institutional models and how will they need to evolve in a world of road user charging?

8:00 a.m.–10:00 a.m.

Part 1: Land Use and Road User Charges (Interactive Session)

Sarah Jo Peterson, Urban Land Institute

10:00 a.m.–10:15 a.m.

Morning Break

10:15 a.m.–noon

Part 2: Institutional Challenges and Opportunities for Agencies Implementing Road User Charges

John Doan, Atkins

Reason Foundation Project in Florida: Examining the Relationship Between Local Toll Authorities and the Florida Turnpike Enterprise

Adrian Moore, Reason Foundation

Conversations with Chinese Officials About Institutional Frameworks and the Linkage of Land Use and Road User Charges in Mainland China

Adrian Moore, Reason Foundation

Private-Sector Perspective Based on Work for Cofiroute on SR 91 and the South Bay Expressway

Gary Hulsizer, Cambria Solutions

Congestion Pricing Institutional Issues Primer: Synthesizing Congestion Pricing Projects Both Nationally and Internationally (based on his research conducted for FHWA)

Myron Swisher, SAIC

Bus Shuttles Depart Beckman Center to the Marriott Newport Beach Hotel and Santa Ana (John Wayne) Airport

Departure time is 12:15 p.m.

Wednesday, June 27, 2012



8:00 a.m.–5:00 p.m., *Executive Dining Room*
AASHTO Peer Exchange (by invitation only)

Effectively Communicating Transportation Funding Issues

Sponsored by the AASHTO Center for Excellence in Project Finance and FHWA, the goals of this peer exchange for members of the AASHTO Standing Committee on Finance and Administration and the AASHTO Standing Committee on Planning are as follows:

- Share emerging and best practices being used by state DOTs to better communicate the complex issues surrounding finance, funding, planning, and project selection during the transportation planning process with the general public and users of the transportation system;
- Identify successful case studies of communication techniques that improved the public's understanding of transportation investment needs, funding options, and program management and implementation by state DOTs in the context of resource constraints in the current economic environment; and
- Begin to develop a best practices resource explaining practical techniques and related tools to the target audience.

12:30 p.m.–1:30 p.m., *Dining Room*
Lunch

3:00 p.m.–3:30 p.m., *Foyer*
Afternoon Break

Bus Shuttle Departs Beckman Center to the Marriott Newport Beach Hotel
Departure time is 5:15 p.m.

UPCOMING EVENTS

2012 TRB Planning Committees Summer Meeting

July 8–11, 2012
Irvine, California

Measuring the Transportation System from a Supply Chain Perspective

July 11, 2012
Irvine, California

Transportation Knowledge Networks—Broadening the Base: A Workshop

July 12–13, 2012
Irvine, California

12th National Light Rail and Streetcar Conference

November 12–13, 2012
Salt Lake City, Utah

TRB Annual Meeting

January 13–17, 2013
Washington, D.C.

Wednesday, June 27, 2012



THE NATIONAL ACADEMIES™
Advisers to the Nation on Science, Engineering, and Medicine

The nation turns to the National Academies—National Academy of Sciences, National Academy of Engineering, Institute of Medicine, and National Research Council—for independent, objective advice on issues that affect people's lives worldwide.
www.national-academies.org

TRANSPORTATION RESEARCH BOARD
OF THE NATIONAL ACADEMIES

500 Fifth Street, NW
Washington, DC
20001